

ALUMINIUM TELESCOPIC LADDER USAGE INSTRUCTIONS

TO EXTEND THE LADDER

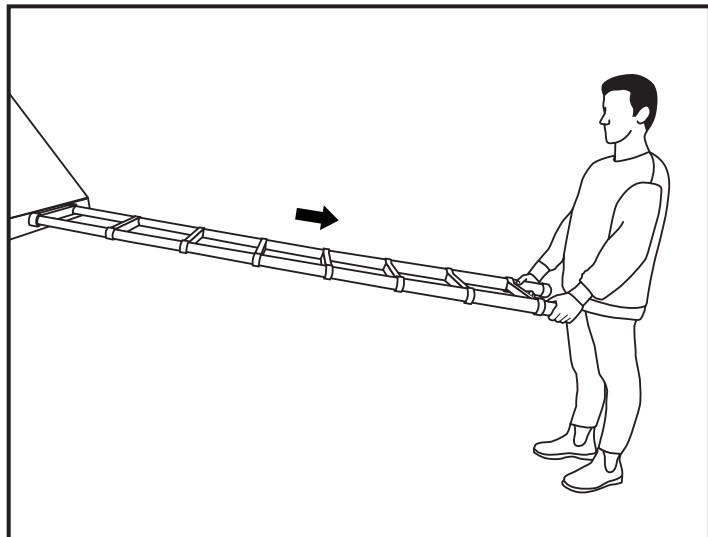

1. When opening the ladder, slowly and sequentially extend the ladder from the top to the bottom, until fully extended.

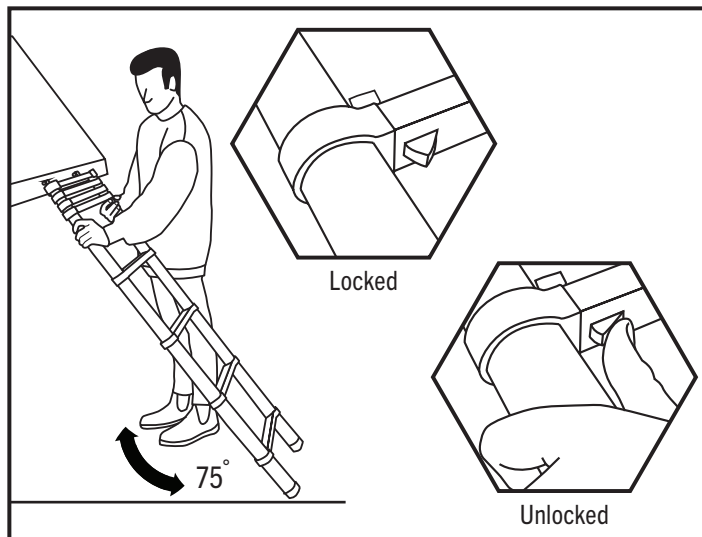

2. Adjust to the correct height by unlocking the top rungs and sliding up. Ensure each rung is locked before using (see locking positions above). Position the ladder at a 75° angle to the ground.

TO COLLAPSE THE LADDER

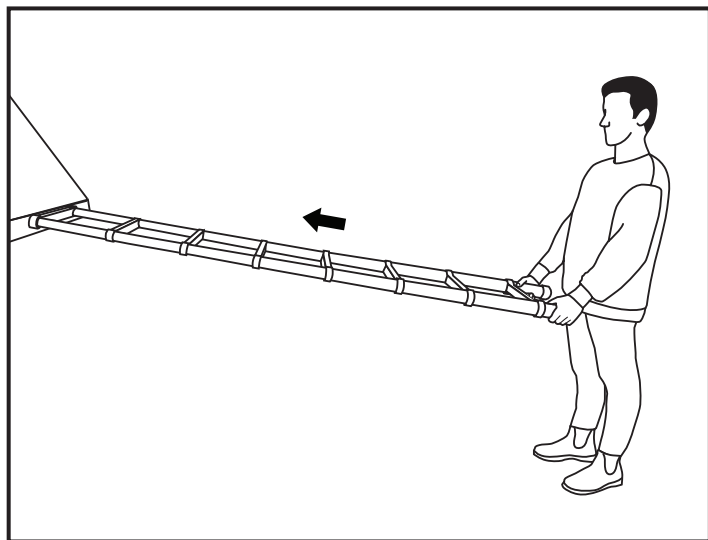

1. When collapsing the ladder, hold the bottom rung and press the left and right release buttons. Hold the ladder frame - not the rung when pressing the release buttons.

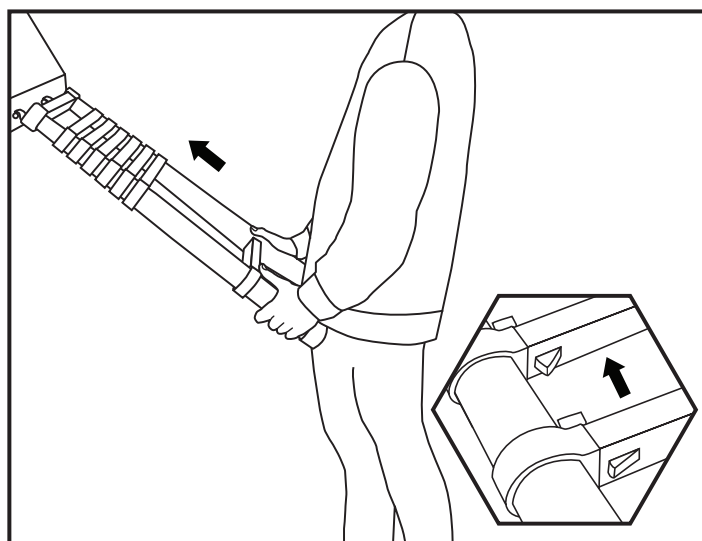

2. Slowly and sequentially collapse the ladder from the lowest rung to the top.