



## SAVANNA 3.5 AIR DELUXE SHELTER

Model No. KC074-830

### PITCHING INSTRUCTIONS

#### YOUR SHELTER INCLUDES:

- 24 x pegs (8mm x 250mm)
- 16 x guy ropes
- 4 x 135mmØ main frame air tubes
- 2 x 100mmØ support air tubes
- 1 x hand pump
- 1 x cross-over valve removal wrench
- 1 x peg mallet
- 1 x repair kit
- 1 x solid flexi wall

1. Select a site to fit the footprint of the shelter: 3.6m W x 2.4m H x 3.6m D, with enough room to pitch out guy ropes. The site should be a level site and clear of any sharp objects. Remove the shelter, pegs and hand pump from the carry bag. Untie the fabric ties and unroll the shelter with the roof facing up.

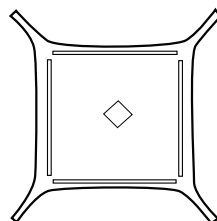

2. Ensure all cross-over valves are in the open position by rotating anticlockwise until tight. Do not over tighten.

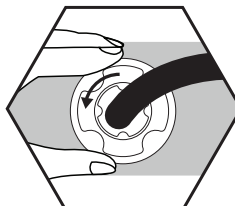

Screw cross-over valve anticlockwise to open

3. Unroll the webbing strap from the corners and connect to the side release buckles on the corresponding corner. This stops the corners from 'splaying' out when inflating the shelter. Peg out the four corners checking the shelter is square.

4. Close the external valves on the legs and remove the top cap, inflate the shelter using the provided pump until the desired PSI is reached.

*Note: You may need to help the air tubes stand up to inflate evenly and in the correct shape, do this by carefully lifting the shelter from the middle.*

*Make sure to only inflate to the recommended pressure (6-8psi), as over-inflation can lead to air tube damage. Replace the top cap of the valve after inflating each air tube.*

*It is recommended in hot weather that 6psi is used to allow for air expansion inside the air tubes. In cooler/windier conditions, 8psi is recommended. Adjust the pressure in the air tubes as the ambient temperature changes. Only use a manual or electric pump with a inbuilt pressure gauge.*

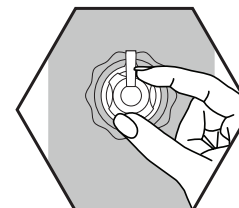

Close external valves

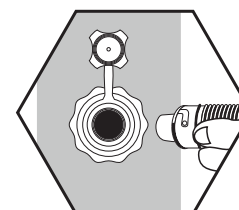

Manual inflation point



5. If you are wanting to attach side walls, it is a good idea to attach them now. Take the weight off the zips when attaching the wall; by holding the side wall up as you zip.

6. Step back and check the shelter is square and sitting correctly. Peg out the remaining pegging points on the four corners, followed by the walls.

7. Peg out the remaining guy ropes. In windy conditions ensure the guy ropes are lengthened close to their full length to provide added strength.

*Note: Use rope springs (sold separately) in high-winds. These provide support and act as shock absorbers by reducing the impact of high-speed wind gusts.*

*To make sure the shelter stays in place, insert the pegs into the ground at a 45° angle.*

8. Close the cross-over valves by turning them clockwise to prevent full deflation in the event of a puncture.
9. Remember this is a temporary shelter, not a structure, so always check it in windy conditions and do not leave it unattended.

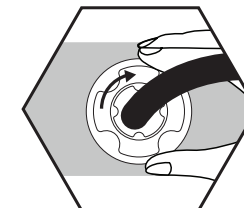

Screw cross-over valve clockwise to close

### REVERSE THE PROCEDURE TO LOWER THE SHELTER PACKING INSTRUCTIONS

1. Pack the poles and pegs into their bags.
2. Fold the shelter from each side to the centre and in half again. Roll towards open valves for most compact size.
3. Store and pack the shelter in its bag.

*Note: NEVER store your shelter wet or dirty (even for short periods of time). This causes mould. If packing away damp, unpack and dry as soon as possible.*

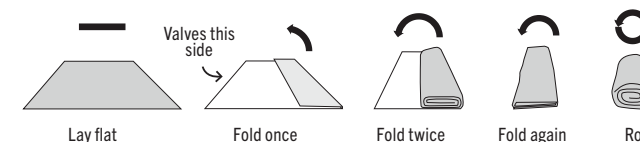

## SHELTER CARE INSTRUCTIONS

**PLEASE READ ALL OF THE SHELTER CARE INFORMATION AND INSTRUCTIONS INCLUDED WITH THIS SHELTER BEFORE USING YOUR SHELTER FOR THE FIRST TIME.**

1. Before you use your new shelter, fully unpack and pitch it at home. It is important to familiarise yourself with the set up procedure and the various features.
2. Select a site that is level, clear of any sharp objects, is dry, will drain well if it rains and is protected from wind and other elements.
3. Keep clear of overhead power lines and trees when setting up your shelter.
4. For best and easiest results, enlist the help of at least one other person to assist in pitching the shelter.
5. Keep all flame and heat sources away from fabric. Do not use open flame or gas appliances in or near your shelter.
6. Do not use aerosol sprays or any solvent based products in or around your shelter as these could damage the fabric or special coatings. These products include but are not limited to: repellent spray, hair sprays, alcohol, detergents, fly spray, petrol, kerosene etc.
7. Please note, the warranty on this shelter will be deemed void if the product is used for any purpose other than a temporary, recreational use shelter.
8. Handle the shelter poles carefully. When unfolding and folding the shelter poles, do not allow the shock cord to pull and snap the ends together. This can damage the poles ends and result in breakage when the pole is tensioned.
9. Especially in windy conditions, it is essential that you attach guy ropes and fasten them to the ground. We suggest you insert the pegs into the ground at a 45° angle towards the shelter, not straight down. Please note, your shelter will not be covered under warranty if wind damage occurs.
10. Use all of the guy ropes and pegs included to ensure your shelter is secure and to prevent damage to both yourself and the shelter. Check guy ropes/pegs daily.

11. When adding accessories, hold both sides of the zip to take pressure off the zips. Ensure that the fabric is never over stretched as this may cause problems with walls and accessories.
12. To clean your shelter, only ever use a soft sponge and warm water. DO NOT use excess force or other harsh cleaners to remove marks from the shelter.
13. Ensure the shelter is completely dry and clean before storing away and ensure to store it in a dry environment.

## IMPORTANT

1. Proper air ventilation is crucial for your comfort and safety. Without adequate ventilation, condensation and carbon monoxide can build up. Although your tent is designed for ventilation under normal conditions, condensation may still occur if it is completely sealed in wet or humid environments. Additionally, carbon monoxide can accumulate from heating appliances and the expulsion of air.
2. Although treated with a fire-retardant coating, no tents are fireproof; if exposed to flame or high heat sources, they can ignite and burn. Keep all flame and heat sources away from this tent fabric. Do not use open flame or gas appliances in or near your tent. In the event of a fire, cut through fabric and evacuate immediately. We recommend keeping a sharp object in any room without an exit, window mesh is the easiest material to cut.
3. DO NOT leave shelter pitched for weeks at a time as extended exposure to the sun's ultraviolet rays can damage and/or cause it to discolour. Your shelter will not be covered under warranty if you leave it up for many weeks at a time.

**FOR MORE INFORMATION  
ON THE SAVANNA 3.5 AIR SHELTER  
SCAN THE QR CODE.**



## STORAGE

1. NEVER store your shelter wet or dirty (even for short periods of time).
2. NEVER store your pegs or poles inside your shelter. Always use the separate bags they are supplied in.
3. You may want to insure your shelter against loss or damage.

## WARRANTY INFORMATION

**The warranty period for this shelter is found on the packaging and full details are on the Kiwi Camping website - [www.kiwicamping.co.nz](http://www.kiwicamping.co.nz).**

The original purchaser of this product is offered a warranty if during this time period the product fails due to a fault in either materials or workmanship. Service under this warranty is available by returning the product, with your proof of purchase, to where it was purchased. If after inspection it is determined that the product is defective, we will repair or replace it (at our discretion) free of charge. This warranty does not cover misuse, damage caused by accident, storm or wind damage, mildew, neglect, UV degradation and fair wear and tear. Please note, the warranty on this shelter will be deemed void if the product is used for any purpose other than a temporary shelter. If the claim is not deemed a warranty or is outside it's warranty period, we can repair the product at a nominal cost.



Distributed by: Aber Living, Hamilton, NZ  
[www.kiwicamping.co.nz](http://www.kiwicamping.co.nz)  
5650-03/25