

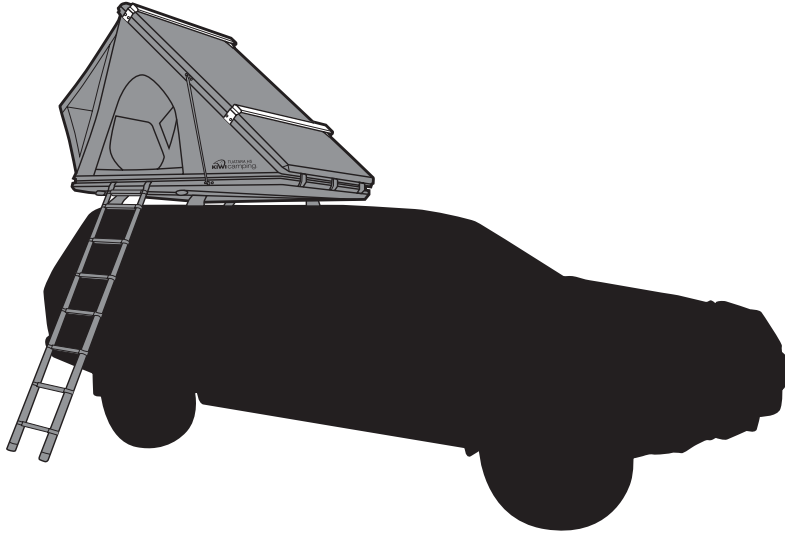

Tuatara HS Tent Top Rails

Model No. KC077-050



SAFETY INSTRUCTIONS

- Regularly check nuts and bolts attaching the Rails to your Rooftop Tent to make sure fastenings are tight and in good condition.
- It is important when mounting Rails to the HS Rooftop Tent, that all the mounting brackets supplied are adequately spaced to support the weight load added.
- Products applied to a vehicle roof will alter vehicle handling. The manufacturer disclaims all responsibility in relation to accidents due to improper use, incorrect maintenance, or negligence in maintaining fastening hardware. It is recommended to not exceed 100km/h.
- When placing extra loads on top of the Hardshell, do not exceed 140kg weight on top of the Tent Top Rails when closed or 15.5kg when the Hardshell is open.

ATTACHMENT INSTRUCTIONS

Your Tuatara HS Tent Top Rail Kit includes:

2 x rails

4 x mounting brackets

8 x M8x35 bolts (hexagon head)

8 x bolts (allen head)

8 x rectangle nuts

INSTALLATION INSTRUCTIONS

1. Position the rails upside down to expose the pre-installed nuts. Align the holes on the mounting bracket to the nuts.
2. Insert the supplied hexagonal head bolts through the holes and fully tighten.
3. Slide two rectangle nuts into each end of the top section of the Hardshell.
4. Carefully lift the rails on top of the Rooftop Tent. Position the rails to allow for even weight distribution. Choose the desired height by choosing the upper or lower bolt holes. Insert the allen head bolts and tighten.

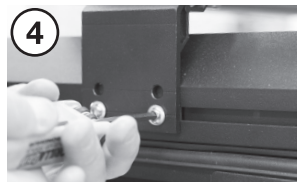

Regularly check all bolts and tighten.

Do not exceed 140kg weight on top of the Tent Top Rails when closed or 15.5kg when the Hardshell is open.

WARRANTY INFORMATION

The warranty period and full details for this product are on the Kiwi Camping website

- www.kiwicamping.co.nz.

 **KIWI** camping®

Distributed by: Aber Living, Hamilton, NZ
www.kiwicamping.co.nz

5290-08/21