

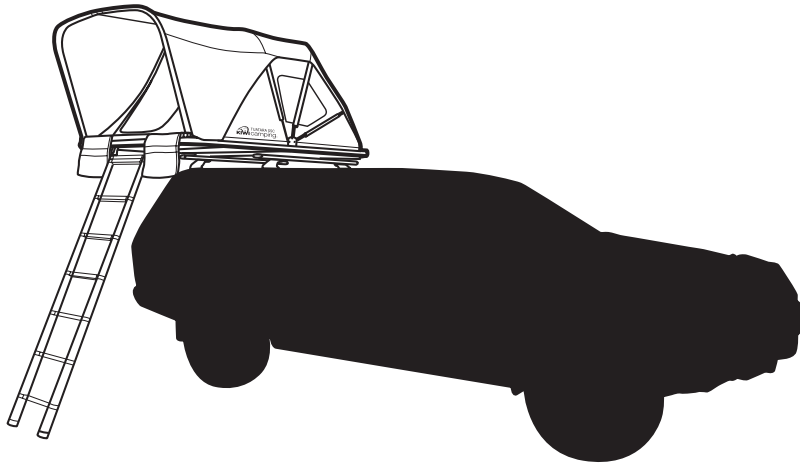

Tuatara SSC Rooftent

Model No. KC077-035



SAFETY INSTRUCTIONS

- Regularly check nuts and bolts attaching the Rooftop Tent to your vehicle to make sure fastenings are tight and in good condition.
- Remove the Rooftop Tent before using a commercial car wash.
- Do not use Rooftop Tent or storage bag to hoist, lift or support yourself.
- It is important when mounting to a vehicle, that all the mounting brackets supplied are adequately spaced to support the weight of the Rooftop Tent.
- Products applied to a vehicle roof will alter vehicle handling. The manufacturer disclaims all responsibility in relation to accidents due to improper use, incorrect maintenance, or negligence in maintaining fastening hardware. It is recommended to not exceed 100km/h.
- This Rooftop Tent will increase the height of your vehicle. Measure the overall height and be aware of height restrictions in car park buildings etc.
- If pitching in windy conditions it is advised to find a less exposed location. Park with the back of the tent facing into the wind. Be aware of dropping branches and other potential hazards. Collapse the tent in strong winds.
- Never drive with roof tent erected.
- Do not put anything on the top of the tent when it is installed.
- The load-bearing of the frame is no more than 250kg.

ATTACHMENT INSTRUCTIONS

Your Tuatara SSC Rooftent includes:

- 1 x pre-assembled Rooftop Tent with ladder attached
- 1 x travel cover
- 4 x mounting brackets
- 8 x M8x50 bolts (hexagon head), 8 x plain washers, 8 x spring washers
- 8 x M8x30 bolts (hexagon head), 8 x plain washers, 8 x spring washers
- 4 x rubber buffers
- 4 x spring ball inserts
- 10 x M8 self-locking nuts
- 4 x plastic end caps
- 4 x spring washers (spare part for frame hinge)
- 1 x 13mm ratchet wrench
- 1 x 6mm allen key

INSTALLATION INSTRUCTIONS

The Tuatara SSC can be fitted to smaller vehicles as long as the fitted roof rack or crossbars support a dynamic weight load of 75kg or higher. We recommend using only permanent roof racks and crossbars. The distance between the car roof and the bottom of the roof rack should be no less than 3cm. The roof rack or crossbars must be between 80-100cm distance apart.

1. Decide on the orientation of your Rooftop Tent. Ensure the two mounting rails attached to the Rooftop Tent are fixed to the correct position and allow for even weight distribution.
2. If the mounting rails need adjusting, loosen the screws adjust the distance or orientation of the rails and then re-tighten screws.
3. Carefully lift the Rooftop Tent on to the roof rack. This will require two people. Insert the the rubber buffers between the mounting rail and the roof rack for extra protection if desired.



4. Position the tent in the centre of your vehicle. Ensure the roof racks are evenly spread under the Rooftop Tent. We recommend keeping the Rooftop tent facing the sides of the vehicle for maximum frame strength.
5. Remove the Travel Cover to access the mounting rails.
6. Attach the Rooftop Tent at the four points where the roof rack and the frame meet. Slide two x M8x50 bolts into both ends of each mounting rail. Position so one bolt is on either side of each roof rack.
Please note: Use the shorter M8x30 bolts if the distance between the car roof and the roof rack is under 4cm. Alternatively, the included spring ball inserts can be inserted into the mounting rail instead of the bolts. Fix these from underneath with bolts provided.
7. Feed the mounting brackets over the bolts. Slide the flat washer on next, followed by a spring washer and finally an M8 self-locking nut. Loosely hand tighten.
8. Check the alignment and balance of the Rooftop Tent before fully tightening all bolts using the ratchet wrench supplied.
9. Insert the plastic end caps into the ends of the mounting rails to prevent wind noise.

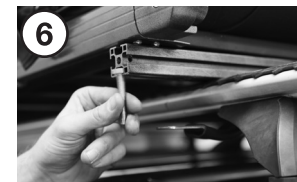

PITCHING INSTRUCTIONS

1. Before opening your Tuatara SSC Rooftop Tent, ensure that all eight bolts are fastened tight so that the tent does not move when opening.
2. To remove the Travel Cover, unclip all four corners and unhook the hooks from the frame. Remove the Travel Cover and store it in a safe, dry place.
3. Undo the compression straps. Unclip the ladder's travel strap and fully extend the ladder until the telescopic rungs click into place.
4. Once the ladder is fully extended, use the ladder as leverage to fold out the extension section on the Rooftop Tent.

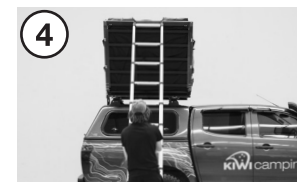

5. Once unfolded, adjust the height of your ladder starting at the top by pushing both black buttons at the same time. Shorten the ladder rungs to the desired length so that it is at a 75° angle and the extension is sitting level with your vehicle. Adjust the ladder to ensure it is firm and that it does not bounce or move.



6. Position the two front poles into the pole slots on the front corners.



7. Attach the porch pole to the front frame to stretch out the front porch.



8. Attach the two hooks on each side of the porch and tighten them with the webbing straps. When tightening, ensure the porch is supported so that the fabric does not get damaged.

9. Once inside the Rooftop Tent, undo the internal bungees that help to pull in the inner when packing down.

10. Partly open the windows to allow for airflow, this will help to reduce condensation build-up.



PACKING INSTRUCTIONS

1. Ensure the Rooftop Tent is dry and clean inside and out before packing down so that mildew or mould does not build up.
2. Make sure nothing heavy or bulky is left inside the Rooftop Tent before folding.
3. Unzip the windows and doors so that the air can escape from the tent when folded. Reattach the internal bungees that will pull in the inner when packing down.
4. Unhook and release the webbing straps. Detach the porch pole and remove the two front poles from the pole slots on the tent corners. The roof will collapse down.
5. Use the extended ladder as leverage to fold the Rooftop Tent in half.
6. To compress the ladder, press and hold both buttons on the bottom rung to collapse it up. Secure with the buckle. Tuck in any excess fabric. The ends of the porch pole can sit outside the edges of the frame.

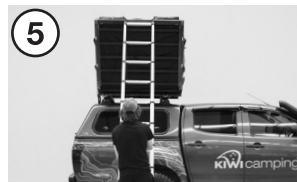

7. Compress the tent by pushing down from the top before securing compression straps.

8. Pull the Travel Cover over the Rooftop Tent. Ensure the reinforced areas of the Travel Cover cover the ladder feet and hinges. Reattach the corner clips. Attach the hooks to the frame to tightly secure.



PRE-CONDITIONING YOUR TENT

You must pre-condition your Rooftop Tent properly before using it for the first time. Here you can take your time and discover the little things, which will make the job easier when you arrive at your destination.

This early weathering process is a very important step as it sets up your Rooftop Tent for the remainder of its life.

Remember, you can never over pre-condition your tent!

IT IS IMPORTANT TO REMEMBER THAT THERE ARE TWO STEPS TO THE PRE-CONDITIONING PROCESS.

1. The entire soaking of the tent: this needs to be done to set the fabric, seams and seal the needle holes in the fabric. If this is not done, your new tent may leak and may continue to do so until conditioning has occurred. While your tent is pitched at home, leave it to weather in continuous rain or thoroughly saturate your tent with a garden hose and allow it to dry, then repeat the process several more times. Rain is the preferred option as sometimes the hose may not wet the fabric enough and you will still get some leakage.
2. Drying out in the sun: this important step swells the cotton thread and shrinks the fabric around it forming a watertight seal. This watertight seal will last the life of the tent. If it is a hot day, it will slow the weathering process so you may need to do this several times. While the tent is drying ensure that it is pitched firmly to control any initial shrinkage.

CARE INSTRUCTIONS

PLEASE READ ALL OF THE CARE INFORMATION AND INSTRUCTIONS INCLUDED WITH THIS ROOFTOP TENT BEFORE USING IT FOR THE FIRST TIME. THE INNER OF THE TUATARA SSC IS POLYCOTTON RIPSTOP AND THE FLY IS POLYESTER.

1. Never store your Rooftop Tent away damp. Should mildew spots appear, brush them off before they become attached. Mildew damage of any kind is not covered by our warranty. DO NOT use excessive force or other harsh tools to remove soilage from your Rooftop Tent.
2. Like all assets, polycotton fabric requires regular care and attention to give the life and service expected. Regular cleaning with an abundance of clean water and a soft brush, especially after exposure to saltwater will preserve your Rooftop Tents life. Do not allow bird droppings, earth or vegetable matter to remain in contact with the fabric. NEVER USE SOAPS OR DETERGENTS.
3. Polycotton fabric is not fireproof, if exposed to flame or high heat sources it can ignite and burn. Always take care when using spirit or gas appliances such as stoves and lanterns near your Rooftop Tent.
4. Some products contain chemicals, which can destroy your Rooftop Tent proofing and cause it to leak. Avoid using aerosol sprays and keep petrol, oil, solvents and other similar fluids away from the fabric. Do not use these inside or around your Rooftop Tent as any damage caused by these is not covered by our warranty.
5. Always remember that your Rooftop Tent is made from cloth, and should not be compared with a house. It is waterproof under normal conditions but in severe weather conditions, some water may penetrate. If you apply waterproofing to your Rooftop Tent, check that you are applying the right one for the polycotton fabric type.
6. Polycotton fabric is not 100% colourfast and some fading will occur naturally, however; this does not affect the performance of the fabric. Do not leave your Rooftop Tent up and unattended for extended periods of time. Rooftop Tents are not designed as permanent dwellings. Rooftop Tents are guaranteed for normal camping use only.
7. Check all fixtures regularly and tighten them when necessary.

IMPORTANT INFORMATION

1. Ensure the Rooftop Tent is clean and dry before it is packed away.
2. Store in a clean, dry space when the Rooftop tent is not attached to your vehicle.
3. Do not clean with harsh chemicals, only use water and a soft cloth.
4. The Travel Cover should always be used when driving.
5. Before using the ladder, ensure that all parts are locked. Check regularly to ensure all parts are in good condition and in working order.
6. Do not use the ladder if only supported by one leg. If on ice or unstable ground, use an anti-skid device under the ladder.
7. When climbing the ladder, face the ladder while climbing and hold firmly. Step in the centre of the rungs. Do not jump off the ladder.
8. Do not adjust the ladder while on the ladder.
9. Before contracting the ladder, ensure it is clean from dirt, dust and grease.
10. The frame and ladder are metal and will conduct electricity, keep away from live electrical currents.
11. The ladder should be at an angle of 75° to the ground when in use.
12. When extending the ladder. Start at the bottom, extend slowly in sequence, locking each rung carefully before moving to the next.
13. When contracting the ladder. Start at the bottom, click the buttons on the underside of the rungs and collapse slowly in sequence, working to the top of the ladder.
14. If the extended ladder isn't sitting flat, reduce the entire ladder first, then extend again to the correct height.
15. Do not use the tent and ladder in extremely high winds.
16. The ladder is designed for one person only, maximum load 150kg.
17. Do not jump inside Rooftop Tent.
18. Do not leave children unattended in or around this Rooftop Tent.

WARRANTY INFORMATION

The warranty period for this tent is found on the packaging and full details are on the Kiwi Camping website - www.kiwicamping.co.nz.

The original purchaser of this product is offered a warranty if during this time period the product fails due to a fault in either materials or workmanship. Service under this warranty is available by returning the product, with your proof of purchase, to where it was purchased. If after inspection it is determined that the product is defective, we will repair or replace it (at our discretion) free of charge. This warranty does not cover misuse, damage caused by accident, storm or wind damage, mildew, neglect, UV degradation and fair wear and tear. Please note, the warranty on this Rooftop Tent will be deemed void if the product is used for any purpose other than a temporary shelter. If the claim is not deemed a warranty or is outside its warranty period, we can repair the product at a nominal cost.



Distributed by: Aber Living, Hamilton, NZ
www.kiwicamping.co.nz

5290-03/22