



IMPORTANT

Read these instructions for use carefully. Familiarise yourself with the appliance before connecting it to its gas container. Keep these instructions for future reference.

ONLY USE IN WELL-VENTILATED AREAS.

CARBON MONOXIDE HAZARD!

USING THIS APPLIANCE IN AN ENCLOSED SPACE MAY CAUSE DEATH. DO NOT USE IN CARAVANS, TENTS, MARINE CRAFT, CARS, MOBILE HOMES OR SIMILAR LOCATIONS.

- Do not modify this appliance.
- Check that seals between the appliance and the gas container are in place and in good condition before connecting the gas container.
- Do not use the appliance if it has damaged or worn seals.
- Do not use this appliance if it is leaking, damaged or does not operate properly.
- This appliance must only be serviced by an authorized person.
- The openings at the base of the burner provide air for combustion, they should never be obstructed. If the flame becomes significantly orange check these openings for a blockage.
- If the appliance cannot be adjusted to perform correctly it should not be used until serviced or repaired.
- To check that the gas container is filled, when shaken a sloshing sound will be heard.
- Do not use the stove when the pan is not located in the central position on the supports.

CAUTION: Accessible parts may be very hot. Keep young children away.

USE OUTDOORS ONLY.

BUTANE PRODUCT

This appliance shall only be used with an 80% butane/20% propane mix gas cartridge certified to EN417 or equivalent.

IT MAY BE HAZARDOUS TO ATTEMPT TO FIT OTHER TYPES OF GAS CONTAINERS.

Only change the gas cartridge in a well ventilated location, preferably outside, away from people and any source of ignition, such as naked flames, pilot flames, and electric heaters/equipment.

If there is a leak on your appliance (smell of gas) and you cannot stop the gas flow, remove the appliance to a well-ventilated location away from any ignition source. Check for leaks using soapy water. Do not try to detect leaks using a flame.

Gasmate®

BACKPACKER STOVE

Model No. BL1157



WARNING

ONLY USE IN WELL VENTILATED AREAS. CARBON MONOXIDE HAZARD - USING THIS APPLIANCE IN AN ENCLOSED SPACE MAY CAUSE DEATH. DO NOT USE IN CARAVANS, TENTS, MARINE CRAFT, CARS, MOBILE HOMES OR SIMILAR LOCATIONS.

Gasmate®

Gasmate® is a registered trademark of: Sitro Group Australia Pty Ltd www.gasmate.com.au
Aber Living, Hamilton, N.Z. www.gasmate.co.nz

Important: Retain these instructions for future use.

GENERAL INFORMATION

INSTRUCTIONS FOR USE

1. Remove appliance from carton and remove any transit protection material.
 - a. The appliance area must be kept clear and free of combustible materials, gasoline and other flammable vapours and liquids.
 - b. Gas orifices and burner must be kept clear of dirt and cobwebs. Flow of combustion and ventilation air through the perforated portions of the appliance must not be obstructed.
 - c. Any cleaning agent used on the appliance should be of a non-combustible and non-corrosive nature.
2. Proper clearance from combustible materials must be maintained at all times. The minimum clearances are as follows:

Minimum Clearance from Combustibles:

Side 600mm **Top** 600mm **Rear** 600mm

Combustible materials are considered to be wood, compressed paper, plant fibres, plastic, plexiglas or other materials capable of being ignited and burned.

Such materials shall be considered combustible even though flame proofed, fire-retardant treated or plastered. Additional clearance may be required for glass, painted surfaces and other materials which may be damaged by radiant or convection heat.

3. Ensure the flame adjustment controller is in the closed position before installing the gas canister. To do this twist the adjustment controller anti-clockwise half a turn to check it is not stuck and then proceed to tighten clockwise to the closed position. Never over tighten; your natural grip should always be sufficient.

4. Attach the appliance to the specified butane cartridge and ensure that control valve is fully closed and the sealing gasket is firmly sealed against neck of connector. In case you have a different cartridge, please consult your supplier for the required adaptors. Control valve is suitable for a butane cartridge with a 7/16" - 28NS male thread.

CAUTION: Some gas may leak when attaching or detaching which is normal. Avoid inhaling the fumes.

5. Unfold the legs and fix them firmly into place before using the stove.
6. Appliance should be operated only on a hard, flat, level non-combustible surface.

LIGHTING THE STOVE

1. Using a fire starter or a match, light the stove firstly by turning the flame controller slowly in an anti-clockwise position. Hold the match or strike the fire starter near the stove so that you hear the ignition. Never open the controller to full or leave the controller open for long periods before lighting to avoid potential burns or fire.

If the stove does not ignite, turn the controller to the off position. Allow stove to cool and repeat the process above.

2. Adjusting the flame: twist the flame control slowly in an anti-clockwise direction. Always perform this slowly.

CAUTION: Parts may become very hot. Make sure the stove is left to cool before touching or putting away in the storage case. Keep away from children or pets.

EXTINGUISHING THE STOVE

1. Twist the flame control slowly clockwise until it stops, and then check to make sure that the flame is completely extinguished.

NOTE: When replacing the gas canister, extinguish the flame and wait until the stove has cooled down sufficiently. When replacing canister always repeat steps 3 – 4 above.

STORAGE

Allow the stove to cool for at least 10 minutes, wipe clean with a dry cloth. Fold the four movable legs together. Place into pouch for compact storage.

When the stove is not used it must be stored in a suitable area to protect it from any risk of deterioration. Keep it in a well ventilated area and out of reach of children.

HANDY HINTS

- a. Inspect the "O" Ring regularly and replace if worn or damaged.
- b. Never connect or disconnect the stove near an open flame.
- c. Check for gas leaks with SOAPY WATER. DO NOT USE A FLAME.
- d. Ensure the stove is completely extinguished before disconnecting from the cartridge.
- e. Avoid moving the stove during use as this can cause large flames.

SAFE APPLIANCE LOCATIONS

This appliance shall only be used in an above ground open-air situation with natural ventilation, without stagnant areas, where gas leakage and products of combustion are rapidly dispersed by wind and natural convection.

Any enclosure in which the appliance is used shall comply with the following:

An enclosure with walls on all sides, but at least one permanent opening at ground level and no overhead cover (see Example 1).

Within a partial enclosure that includes an overhead cover and no more than two walls (see Example 2 & 3).

Within a partial enclosure that includes an overhead cover and more than two walls, the following will apply:

at least 25% of the total wall area is completely open, and at least 30% of the remaining wall area is open and unrestricted (see Example 4 & 5).

In the case of balconies, at least 20% of the total wall area shall be and remain open and unrestricted.

DIAGRAMMATIC REPRESENTATIONS OF OUTDOOR AREAS

The following figures are diagrammatic representations of outdoor areas. Rectangular areas have been used in these figures – the same principles apply to any other shaped area.

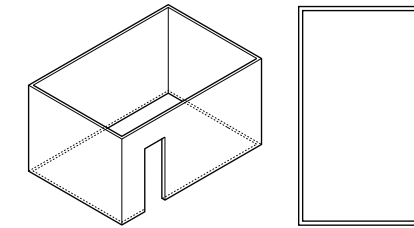

Outdoor Area - Example 1

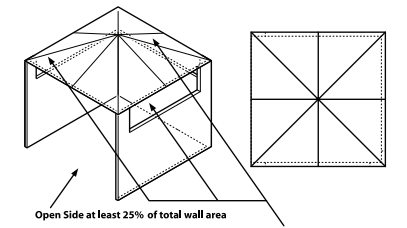

Outdoor Area - Example 4

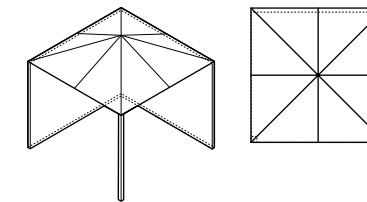

Outdoor Area - Example 2

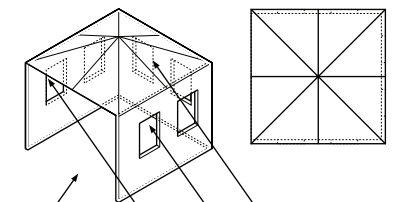

Outdoor Area - Example 5

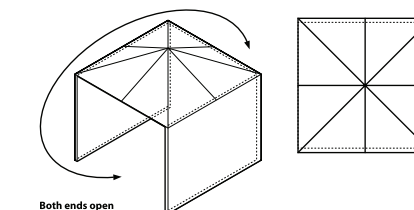

Outdoor Area - Example 3



WARNING

Be very careful when turning the burner down. Visually check to ensure the flame does not go out.